

# PRODUCT INFORMATION

## ANIKA

 40 - 50 kg

 57 - 86 mm

 55 - 75 mm

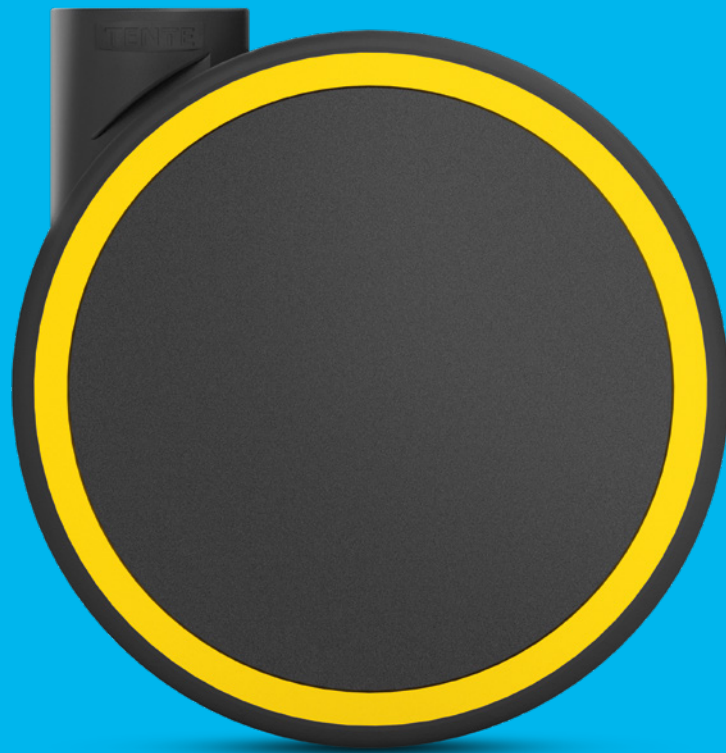

**TENTE**

BETTER MOBILITY. BETTER LIFE.

# ANIKA

Full choice of customisable product solutions.



**HOUSINGS**  
Pages: 4-7



**WHEELS**  
Pages: 8-13



**FITTINGS**  
Pages: 14-22

# ANIKA EVO

Product made of biosourced material.



**EVO VERSION**  
Pages: 23-33

## BETTER MOBILITY IN PREMIUM QUALITY

TENTE believes in smart mobility solutions which noticeably improve people's lives and their work environment. TENTE solutions increase productivity, ensure safety and open up new horizons in matters of design and durability as well as environmental friendliness. Leading manufacturers and companies from different industries rely on these competencies and our high production quality.

On the following pages you will find technical information about our Anika product family. We will also explain the added value this mobility solution offers to your organisation. Features include:

### Sustainable material

Version made of biosourced material.

### Customised design

Different brake lever available and customisable, for fitted design.

### Colour matching

The colour of solid material can be adapted to the product design. Please contact us for your desired colour.



# HOUSINGS



## FEATURES

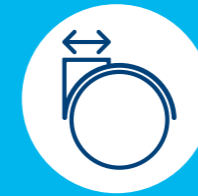

### Visual integration

Different dome diameters and designs allow for a perfect transition from the castor to the application.

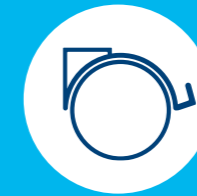

### Customised design

Different brake lever available and customisable, for fitted design.



### Optimised manoeuvrability

The differential effect of the twin-wheel castor allows for increased manoeuvrability.



### Painted surface

Gold, chrome, aluminium or glossy colours.



### Ergonomic foot pedal

Easily accessible pedal for manual wheel lock.



### Reduced risk of accidents

Automatic load-dependent wheel brake to prevent accidents with office chairs.



### Prevents unintended movement

Wheel lock with pedal for manual operation.



### Colour matching

The colour of solid material can be adapted to the product design. Please contact us for your desired colour. Standard colours:

- |            |             |
|------------|-------------|
| ● RAL 9011 | ● RAL 9003  |
| ● RAL 7001 | ● RAL 9002  |
| ● PMS 116C | ● PMS 186C  |
| ● PMS 376C | ● PMS 2935C |

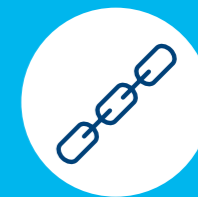

### Robust housing

Twin wheel castor for high stability and low height.

# HOUSINGS

The elegant housing is made of premium virgin polyamide. We're able to verify the origin of all the materials used and that means you can be assured of the quality of the products we make. The housing is high shock absorbing. The materials are tested in our own laboratory for compliance with European standards. Non hazardous materials are used in order to comply with the RoHS directive and REACH regulation of the European Union. These do not contain polycyclic aromatic hydrocarbons or chromium (VI). All components are resistant to many cleaning agents and chemical substances.



**Swivel castor**  
Wheel and housing are free to move for an easy manoeuvrability.



**Wheel brake**  
Wheel lock with pedal for manual operation that prevents unintended movement.



**Intermittent brake**  
Reduced risk with automatic load-dependent wheel brake to prevent accidents.

## Technical data and availability



Description	Housing type	Swivel castor	Swivel castor with wheel brake	Swivel castor with intermittent brake
	Article description	5920	5925	5923
	Material	Premium quality virgin polyamide	Premium quality virgin polyamide	Premium quality virgin polyamide
	Swivel bearing	Plain bearing	Plain bearing	Plain bearing
Swivel interference	Wheel $\varnothing$ 55 mm	96 mm	127 mm	96 mm
	Wheel $\varnothing$ 65 mm	111 mm	152 mm	111 mm
	Wheel $\varnothing$ 75 mm	128,8 mm	175,4 mm	-

Items with this sign „-“ are not available in our standard range. Please contact us.

### Swivel bearing

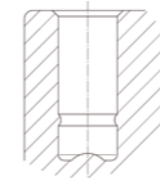

Plain bearing for plug-in fittings.

# CUSTOMISED DESIGN

Different dome diameters are available and customisable to ensure castors can easily fit to your application. The brake lever can also be customised. This is available on 65 mm diameter wheels and, on request, for other diameters. Here you can find our standard versions and some examples of customised versions to give you an idea what is possible.



Standard dome



Standard brake pedal

## Examples for customised domes



## Examples for customised brake pedals



# WHEELS



## FEATURES

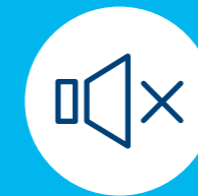

### Quiet rolling

Soft wheel versions for a quiet working environment.



### Painted surface

Gold, chrome, aluminium, or glossy coloured.



### Individual branding

Can be printed with a logo.



### Fascinating picture prints

You can print an image onto your entire wheel cap.



### Non-marking movement

Wheels with reduced abrasion and little cleaning requirement.



### Reduced cleaning

The castors are quick and easy to clean, with smooth surfaces.



### Colour matching

Colours can be adapted to match the product design. You can choose a matte or glossy finish. Please contact us for your desired colour. Standard colours of the wheel caps:

- RAL 9011    ● RAL 9003
- RAL 7001    ● RAL 9002
- PMS 116C   ● PMS 186C
- PMS 376C   ● PMS 2935C



### Non hazardous materials

Complies with the RoHS directive and REACH regulation of the European Union. Does not contain polycyclic aromatic hydrocarbons or chromium (VI).



### Certified quality

Tested in our own test laboratory for compliance with European standards.

# WHEELS

The characteristics of the wheel depend on the material. These wheels require minimal cleaning and leave no marks or stains on floors, even during long standing periods. They can be used for all kind of floors from untreated wood to natural stone or soft carpet.







**Duratech**  
Stable and indestructible, made of polyamide.



**Maxtech**  
Perfect for functional design, injection-moulded polyurethane.

## Technical data and availability

			
Description	<b>Product name</b>	Duratech	Maxtech
	<b>Article description</b>	UOI	UAI
	<b>Tread material</b>	Polyamide	Polyurethane
	<b>Tread hardness</b>	Shore D 75	Shore A 92
	<b>Wheel body material</b>	Polyamide	Polyamide
	<b>Temperature range</b>	-10°C / +40°C	-10°C / +40°C
	<b>Width of tread</b>	11 mm	11 mm
Bearing type	Plain bearing		
Load capacity	Wheel Ø 55 mm	40 kg	40 kg
	Wheel Ø 65 mm	-	50 kg
	Wheel Ø 75 mm	-	50 kg

### Bearing type



Plain bearing for short distances.

Items with this sign „-“ are not available in our standard range. Please contact us.



### Load capacity

The load capacity depends on the housing and wheel. It has been tested and fulfils the requirements according to EN 12528. When using four castors, determine the necessary load capacity as follows: The sum of the weight of your application plus the additional load divided by 3 castors.

$$\frac{\text{Weight of application} + \text{load}}{3} = \text{Load capacity of one castor}$$



## CUSTOMISED DESIGN

Our product family Anika offers a wide range of possible customisations. This includes picture prints and plenty more besides. We can accommodate our customers' individual design preferences. Please contact us: [www.tente.com/locations](http://www.tente.com/locations)



Surface treatments



Colour matching



Individual branding



Picture prints



# FITTINGS



## FEATURES



### Fast assembly

Faster assembly thanks to easy plug-in fittings.

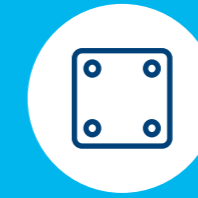

### Variable fitting options

Wide range of fittings in various sizes.

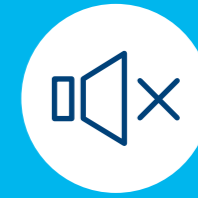

### Quiet rolling

Noise-reduced fittings for a quiet working environment.

## ADDITIONAL FEATURES



### Award-winning design

Awarded with prestigious prizes by international juries.



### Compliant version

Used for furniture (EN12528) and office chairs (EN12529 and BIFMA).



### Reduced cleaning

The castors are quick and easy to clean thanks to their smooth surfaces.



### Chemical-resistant components

Resistant to many cleaning agents and chemical substances.

# PLUG-IN PLATE FITTINGS

For castors with a blind hole, different plug-in plate fittings are available.

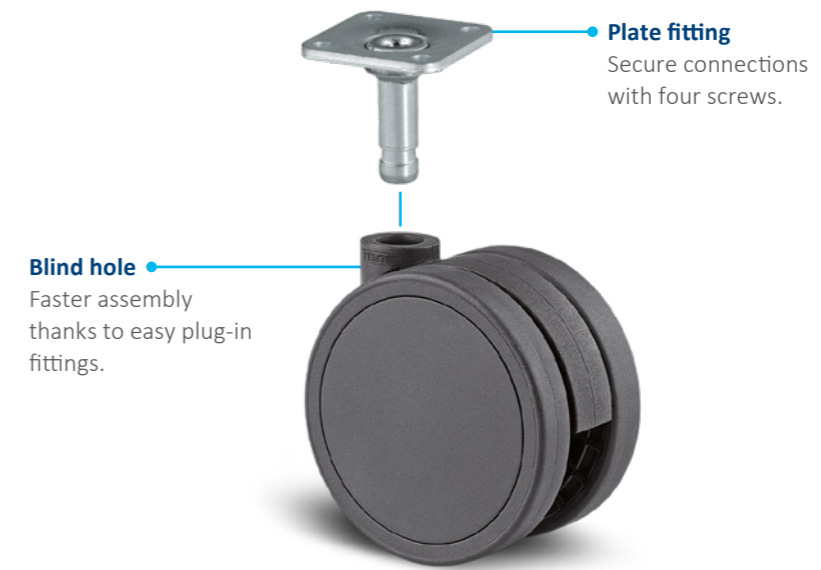

## Technical data and availability

Description	Fitting type	Blind hole	Blind hole	Stem with U-shaped plate	Stem with L-shaped plate	Stem with plate	Stem with plate	Stem with plate	Stem with plate	Stem with plate
	Article description	L51-10	L51-8	P10-40	P11	P41	P41	P41	P40	P41
	Size of plate	-	-	40 x 15 mm 40 x 16 mm 40 x 17 mm 40 x 18 mm 40 x 20 mm 40 x 22 mm 40 x 25 mm	40 x 16 40 x 17 40 x 19 40 x 22 40 x 25	30 x 30 mm	38 x 38 mm	42 x 42 mm	60 x 60 mm	65 x 65 mm
	Plate hole centres	-	-	-	-	20 x 20 mm	27 x 27 mm	32 x 32 mm	48/38 x 48/38 mm	47/42 x 47/42 mm
	Plate hole Ø	-	-	4 mm	4 mm	4,4 mm	5,1 mm	5,1 mm	6,3 mm	6,3 mm
	Blind hole Ø	10 mm	8 mm	-	-	-	-	-	-	-
	Compatible with blind hole Ø	-	-	8 mm	8 mm	8 mm	8 mm 10 mm	8 mm 10 mm	10 mm	10 mm
Overall height	Wheel Ø 55 mm	57 mm	57 mm	65 mm	65 mm	68 mm	68 mm	68 mm	68 mm	66,5 mm
	Wheel Ø 65 mm	67 mm	67 mm	75 mm	75 mm	78 mm	78 mm	78 mm	78 mm	76,5 mm
	Wheel Ø 75 mm	77 mm	-	-	-	-	88 mm	88 mm	88 mm	86,5 mm

Items with this sign „-“ are not available in our standard range. Please contact us.

# PLUG-IN THREADED STEM FITTINGS

For castors with a blind hole fitting, different plug-in threaded stem fittings are available.

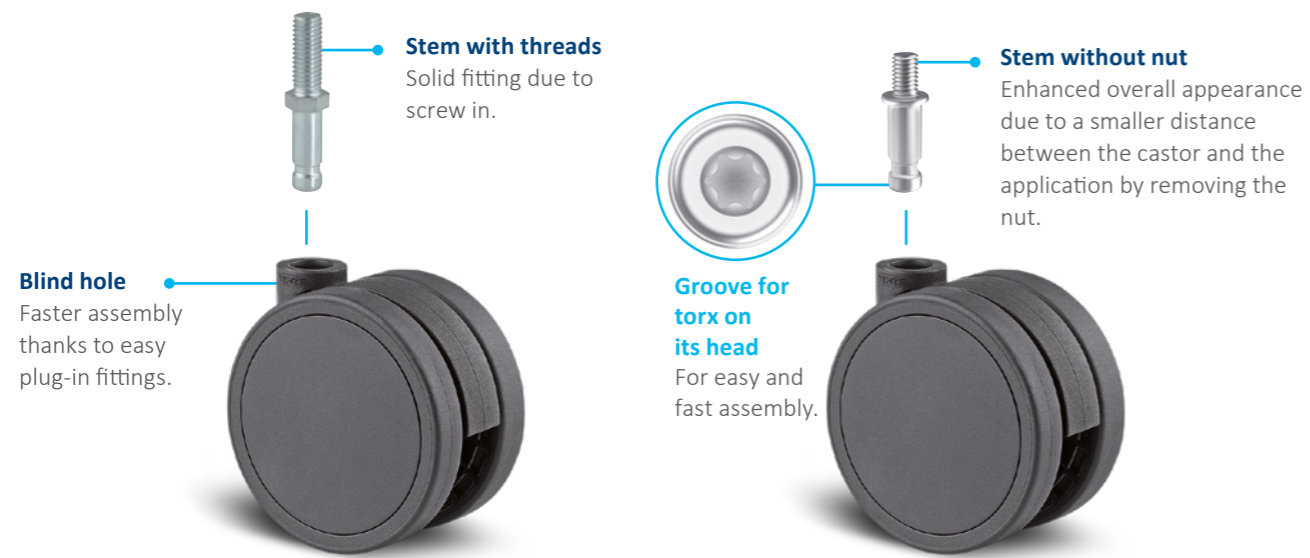

## Technical data and availability

Description	<b>Fitting type</b>	Blind hole	Blind hole	Threaded stem	Threaded stem	Threaded stem	Threaded stem	Threaded stem with groove for torx
	<b>Article description</b>	L51-10	L51-8	S10	S70	S70	S70	S73
	<b>Threaded stem measurements</b>	-	-	7 x 25 mm	M6 x 12 mm M6 x 25 mm M8 x 10 mm M8 x 12 mm M8 x 15 mm M8 x 25 mm M8 x 34 mm M10 x 10 mm M10 x 15 mm M10 x 25 mm	M8 x 15 mm M10 x 10 mm M10 x 15 mm M10 x 25 mm M10 x 35 mm M10 x 50 mm	M10 x 78 mm	M8 x 12 mm
	<b>Blind hole Ø</b>	10 mm	8 mm	-	-	-	-	-
	<b>Compatible with blind hole Ø</b>	-	-	8 mm	8 mm	10 mm	10 mm	10 mm
Overall height	<b>Wheel Ø 55 mm</b>	57 mm	57 mm	65 mm	63 mm	63 mm	66 mm	66 mm
	<b>Wheel Ø 65 mm</b>	67 mm	67 mm	75 mm	73 mm	73 mm	76 mm	76 mm
	<b>Wheel Ø 75 mm</b>	77 mm	-	-	-	83 mm	86 mm	86 mm-

Items with this sign „-“ are not available in our standard range. Please contact us.

# EXPANDING FITTINGS FOR TUBES

The adjustable expanders allow for flexible installation in different tube sizes. This can be used for all castors with blind holes with wheel diameter Ø 10 mm.



## Technical data and availability

Description	<b>Fitting type</b>	Blind hole	Expander, round	Expander, square
	<b>Article description</b>	L51-10	R07	R47
	<b>Expander measurements</b>	-	Ø 19 - 21,5 mm Ø 21,5 - 24 mm Ø 24 - 27 mm Ø 27 - 30 mm Ø 31 - 35 mm	21,5 - 24 mm 24 - 27 mm 27 - 30 mm 32 - 35 mm 36 - 40 mm
	<b>Bolt hole Ø</b>	10 mm	-	-
	<b>Compatible with blind hole Ø</b>	-	10 mm	10 mm
Overall height	<b>Wheel Ø 55 mm</b>	57 mm	-	-
	<b>Wheel Ø 65 mm</b>	67 mm	-	-
	<b>Wheel Ø 75 mm</b>	77 mm	-	-

Items with this sign „-“ are not available in our standard range. Please contact us.

# PLUG-IN STEM FITTINGS

For all castors with a blind hole fitting, different plug-in fittings are available to allow for a faster assembly. These fittings are efficient and easy to install.



## Technical data and availability

Description	Fitting type	Blind hole	Blind hole	Stem with grooves	Stem with circlip	Stem with circlip	Collar stem	Collar stem with circlip	Collar stem with circlip	Collar stem with synthetic circlip
	Article description	L51-10	L51-8	R10	B11	B11	B20	B10	B10	B40
	Stem measurements (Ø x Length)	-	-	8 x 10 mm 8 x 20 mm 8 x 28 mm	8 x 33 mm	10 x 33 mm	7 x 36 mm	10 x 20 mm 11 x 20 mm 11 x 30 mm	9 x 24 mm	11 x 20 mm
	Blind hole Ø	10 mm	8 mm	-	-	-	-	-	-	-
	Compatible with blind hole Ø	-	-	8 mm	8 mm	10 mm	8 mm	8 mm* 10 mm	10 mm	10 mm
Overall height	Wheel Ø 55 mm	57 mm	57 mm	60 mm	57 mm	57 mm	61 mm	61,5 mm	61,5 mm	61,5 mm
	Wheel Ø 65 mm	67 mm	67 mm	70 mm	67 mm	67 mm	71 mm	71,5 mm	71,5 mm	71,5 mm
	Wheel Ø 75 mm	77 mm	-	-	-	77 mm	-	81,5 mm	81,5 mm	81,5 mm

Items with this sign „-“ are not available in our standard range. Please contact us.  
\* Just collar stem B10 in 11 x 20 mm is also available for blind hole Ø 8mm.

# SOCKETS

For an easy and solid assembly under different applications, the plug-in collar stem fittings can be used with different sockets.

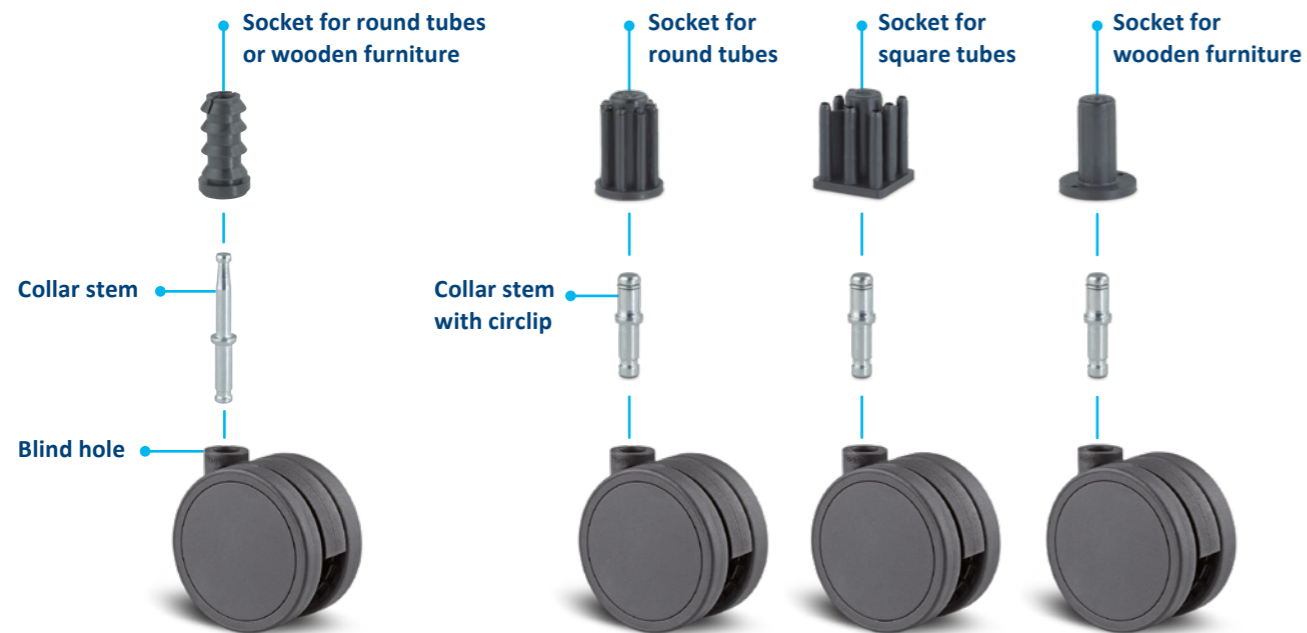

## Technical data and availability



i		Socket type	Round socket for tubes or wooden furniture*	Round Socket for tubes	Square socket for tubes	Round socket for wooden furniture
Description	Article description	R20	R20	R40	H40	
	Compatible with product	B20 7 x 36 mm	B10 11 x 30 mm	B10 11 x 30 mm	B10 11 x 30 mm	
	Socket Ø / collar Ø	10 / 18 mm* 12 / 17 mm 13 / 17 mm 14 / 17 mm 16 / 20 mm 18 / 20 mm 20 / 23,5 mm 23 / 25 mm	14 / 18 mm 15 / 18 mm 16 / 18 mm 17 / 19 mm 18 / 20 mm 19 / 21 mm 20 / 21 mm 22 / 25 mm 23 / 26 mm	16 / 20 mm 17 / 19 mm 18 / 20 mm 21 / 23,5 mm 22 / 24,5 mm 23 / 25,5 mm 26 / 30 mm	15 mm	
	Socket height	27 mm	36 mm	36 mm	36 mm	

\* Socket R20 in size 10 / 18 mm is without ribs and for wooden furniture, all the others for tubes. It has a height of 29 mm.

# ANIKA EVO



# ANIKA EVO

The Anika is also available as "evo" version which is made of up to 98%\* biomass materials originating from the castor bean. The elegant housing is made of premium biosourced polyamide. We are able to verify the origin of the biosourced materials used and that means you can be assured of the quality of the products we produced. The housing is high shock absorbing.

\* 98% calculated from the total weight of synthetic material used to manufacture our product.



**Sustainable material**  
The housing is made of biosourced material.

## Housing versions



Description	Housing type	Swivel castor	Swivel castor with wheel brake
	Article description	T920	T925
	Material	Housing made of biosourced Polyamide	Housing made of biosourced Polyamide
	Swivel bearing	Plain bearing	Plain bearing
Swivel interference	Wheel Ø 55 mm	96 mm	127 mm
	Wheel Ø 65 mm	111 mm	152 mm

Swivel bearing

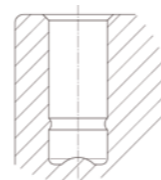

Plain bearing for plug-in fittings.

# JOIN TENTE FOR A MORE SUSTAINABLE FUTURE WITH ANIKA EVO

Environmental protection is important to all of us. It is for this very reason that TENTE wants to set an example and to leave a green footprint on our valuable planet. Therefore, we are proud to present:

**Anika evo – the first castor product range made of plant-based material.**

Anika evo is made of up to 98%\* biomass materials originating from the castor bean. The Anika evo castor offers the same product quality and colour flexibility as the well-known Anika castor. In producing a sustainable furniture castor, TENTE is the first manufacturer ever to incorporate the castor bean into a furniture castor. The utilization of the castor bean helps us to reduce the carbon footprint by 46%\*\*.

TENTE'S DNA consists of developing and exploring new possibilities – product development for a more sustainable future is no exception. You can be a part of this sustainable journey!



## Extraction of biomass material

\* 98% calculated from the total weight of synthetic material used to manufacture our product.  
\*\* 46% calculated according to the life cycle management ISO 14040 and 14044 standards.

## Percentage of renewable resources



Description	Housing type	Swivel castor	Swivel castor with wheel brake	Swivel castor	Swivel castor with wheel brake
	Wheel type	Hard wheel	Hard wheel	Soft wheel	Soft wheel
Percentage of renewable resources	Wheel Ø 55 mm	97,77% (fitting L51-8) 97,87% (fitting L51-10)	98% (fitting L51-8) 98,09% (fitting L51-10)	78,01% (fitting L51-8) 77,79% (fitting L51-10)	80,06% (fitting L51-8) 79,89% (fitting L51-10)
	Wheel Ø 65 mm	-	-	72,29% (fitting L51-8) 72,19% (fitting L51-10)	74,25% (fitting L51-8) 74,16% (fitting L51-10)

Items with this sign „-“ are not available.



### Colour matching

The colour of solid material can be adapted to the product design. Please contact us for your desired colour.

### Standard colours:

- RAL 9011
- RAL 9003
- RAL 7001
- RAL 9002
- PMS 116C
- PMS 186C
- PMS 376C
- PMS 2935C

## Wheel versions



Description	Product name	Duratech	Maxtech
	Article description	KOI, AOI	KBI, AXI
Tread material	Biosourced Polyamide	Biosourced Polyamide	
Tread hardness	Shore D 61	Shore A 90	
Wheel body material	Biosourced Polyamide	Biosourced Polyurethane	
Temperature range	-10°C / +40°C	-10°C / +40°C	
Width of tread	11 mm	11 mm	
Electric conductive (10 <sup>4</sup> OHM)	On request	On request	
Bearing type	Plain bearing	●	●
	Load capacity	40 kg	40 kg
Load capacity	Wheel Ø 65 mm	50 kg (to be tested)	50 kg (to be tested)

### Bearing type



Plain bearing for short distances.



### Load capacity

The load capacity depends on the housing and wheel. It has been tested and fulfils the requirements according to EN 12528. When using four castors, determine the necessary load capacity as follows: The sum of the weight of your application plus the additional load divided by 3 castors.

$$\frac{\text{Weight of application} + \text{load}}{3} = \text{Load capacity of one castor}$$

## Fitting version: Plug-in plate fitting

For castors with a blind hole, different plug-in plate fittings are available.

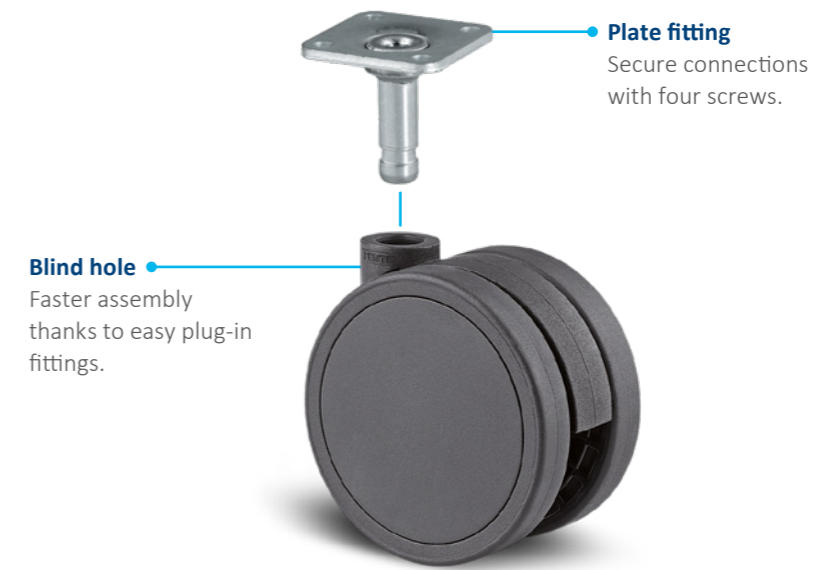

## Technical data and availability

Description	Fitting type	Blind hole	Blind hole	Stem with U-shaped plate	Stem with L-shaped plate	Stem with plate	Stem with plate	Stem with plate	Stem with plate	Stem with plate
	Article description	L51-10	L51-8	P10-40	P11	P41	P41	P41	P40	P41
	Size of plate	-	-	40 x 15 mm 40 x 16 mm 40 x 17 mm 40 x 18 mm 40 x 20 mm 40 x 22 mm 40 x 25 mm	40 x 16 40 x 17 40 x 19 40 x 22 40 x 25	30 x 30 mm	38 x 38 mm	42 x 42 mm	60 x 60 mm	65 x 65 mm
	Plate hole centres	-	-	-	-	20 x 20 mm	27 x 27 mm	32 x 32 mm	48/38 x 48/38 mm	47/42 x 47/42 mm
	Plate hole Ø	-	-	4 mm	4 mm	4,4 mm	5,1 mm	5,1 mm	6,3 mm	6,3 mm
	Blind hole Ø	10 mm	8 mm	-	-	-	-	-	-	-
	Compatible with blind hole Ø	-	-	8 mm	8 mm	8 mm	8 mm 10 mm	8 mm 10 mm	10 mm	10 mm
Overall height	Wheel Ø 55 mm	57 mm	57 mm	65 mm	65 mm	68 mm	68 mm	68 mm	68 mm	66,5 mm
	Wheel Ø 65 mm	67 mm	67 mm	75 mm	75 mm	78 mm	78 mm	78 mm	78 mm	76,5 mm

Items with this sign „-“ are not available in our standard range. Please contact us.



## Fitting version: Plug-In threaded stem fittings

For castors with a blind hole fitting, different plug-in threaded stem fittings are available.

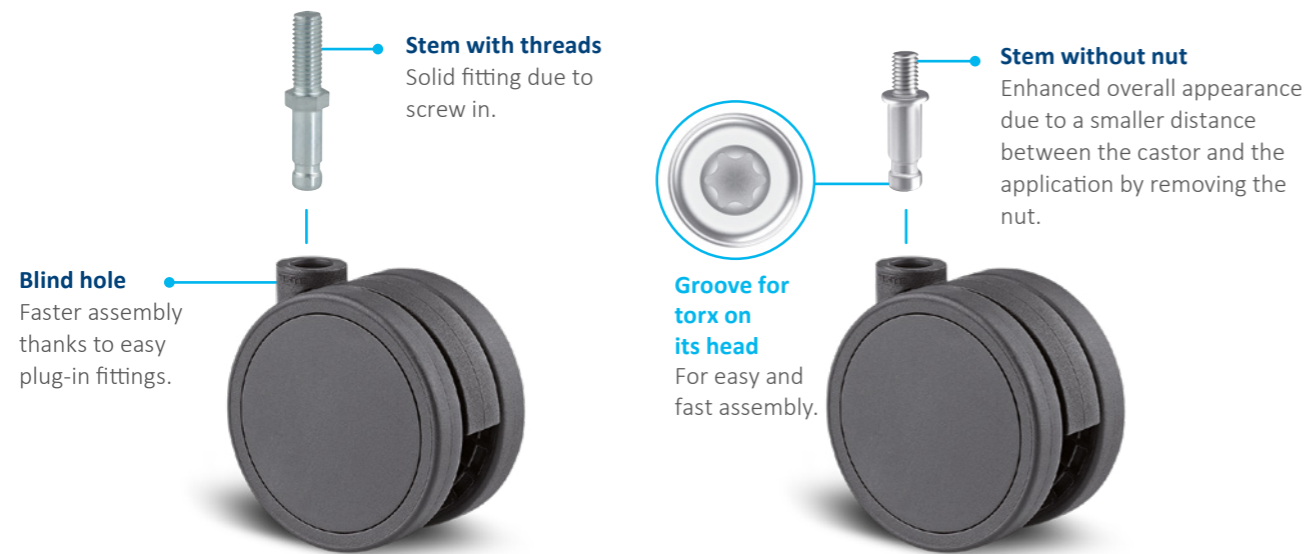

## Technical data and availability

Description	<b>Fitting type</b>	Blind hole	Blind hole	Threaded stem	Threaded stem	Threaded stem	Threaded stem	Threaded stem with groove for torx
	<b>Article description</b>	L51-10	L51-8	S10	S70	S70	S70	S73
	<b>Threaded stem measurements</b>	-	-	7 x 25 mm	M6 x 12 mm M6 x 25 mm M8 x 10 mm M8 x 12 mm M8 x 15 mm M8 x 25 mm M8 x 34 mm M10 x 10 mm M10 x 15 mm M10 x 25 mm	M8 x 15 mm M10 x 10 mm M10 x 15 mm M10 x 25 mm M10 x 35 mm M10 x 50 mm	M10 x 78 mm	M8 x 12 mm
	<b>Blind hole Ø</b>	10 mm	8 mm	-	-	-	-	-
	<b>Compatible with blind hole Ø</b>	-	-	8 mm	8 mm	10 mm	10 mm	10 mm
Overall height	<b>Wheel Ø 55 mm</b>	57 mm	57 mm	65 mm	63 mm	63 mm	66 mm	66 mm
	<b>Wheel Ø 65 mm</b>	67 mm	67 mm	75 mm	73 mm	73 mm	76 mm	76 mm

Items with this sign „-“ are not available in our standard range. Please contact us.

## Fitting version: Expanding fittings for tubes

The adjustable expanders allow for flexible installation in different tube sizes. This can be used for all castors with blind holes with wheel diameter Ø 10 mm.



## Technical data and availability

Description	<b>Fitting type</b>	Blind hole	Expander, round	Expander, square
	<b>Article description</b>	L51-10	R07	R47
	<b>Expander measurements</b>	-	Ø 19 - 21,5 mm Ø 21,5 - 24 mm Ø 24 - 27 mm Ø 27 - 30 mm Ø 31 - 35 mm	21,5 - 24 mm 24 - 27 mm 27 - 30 mm 32 - 35 mm 36 - 40 mm
	<b>Bolt hole Ø</b>	10 mm	-	-
	<b>Compatible with blind hole Ø</b>	-	10 mm	10 mm
Overall height	<b>Wheel Ø 55 mm</b>	57 mm	-	-
	<b>Wheel Ø 65 mm</b>	67 mm	-	-

Items with this sign „-“ are not available in our standard range. Please contact us.

## Fitting version: Plug-In stem Fittings

For all castors with a blind hole fitting, different plug-in fittings are available to allow for a faster assembly. These fittings are efficient and easy to install.

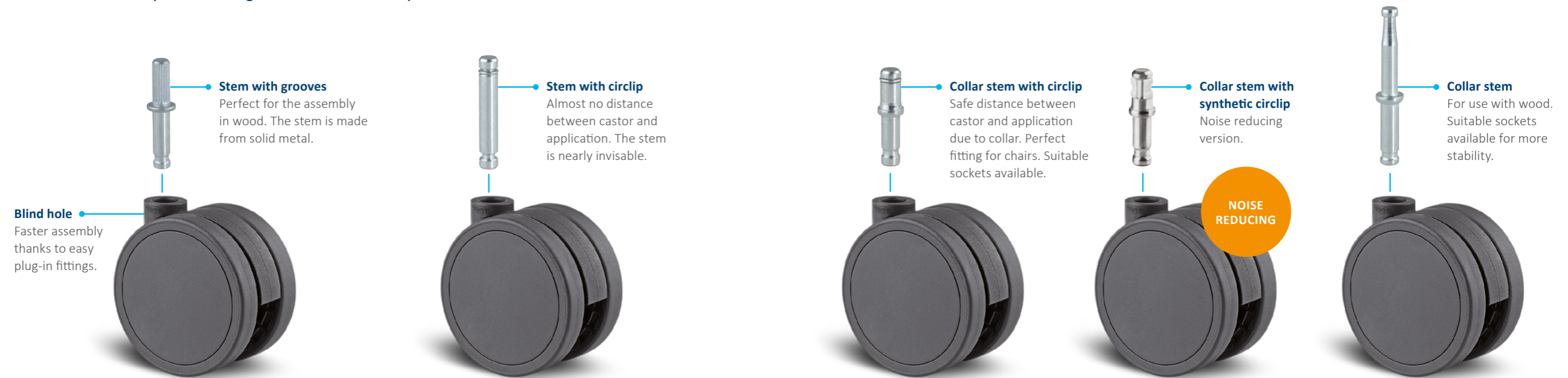

## Technical data and availability

<b>Fitting type</b>	Blind hole	Blind hole	Stem with grooves	Stem with circlip	Stem with circlip	Collar stem	Collar stem with circlip	Collar stem with circlip	Collar stem with synthetic circlip
<b>Article description</b>	L51-10	L51-8	R10	B11	B11	B20	B10	B10	B40
<b>Stem measurements (Ø x Length)</b>	-	-	8 x 10 mm 8 x 20 mm 8 x 28 mm	8 x 33 mm	10 x 33 mm	7 x 36 mm	10 x 20 mm 11 x 20 mm 11 x 30 mm	9 x 24 mm	11 x 20 mm
<b>Blind hole Ø</b>	10 mm	8 mm	-	-	-	-	-	-	-
<b>Compatible with blind hole Ø</b>	-	-	8 mm	8 mm	10 mm	8 mm	8 mm* 10 mm	10 mm	10 mm
<b>Wheel Ø 55 mm</b>	57 mm	57 mm	60 mm	57 mm	57 mm	61 mm	61,5 mm	61,5 mm	61,5 mm
<b>Wheel Ø 65 mm</b>	67 mm	67 mm	70 mm	67 mm	67 mm	71 mm	71,5 mm	71,5 mm	71,5 mm



Find suitable sockets on page 22.

Items with this sign „-“ are not available in our standard range. Please contact us.

\* Just collar stem B10 in 11 x 20 mm is also available for blind hole Ø 8mm.

# DIVERSITY WITH A SYSTEM OUR CASTORS

All of our products have their own specific qualities and strengths. Whether it's high design standards, specialist applications or exceptional load capacities – our range can meet your needs and can be adapted to fit different models.

From the correct dimensions and technical specifications to the required configuration, our product families are able to offer the ideal solution – whatever you need. Please contact us for more information or visit our website: [www.tente.com](http://www.tente.com)

<p><b>Radiata</b></p>  <p>1.200 - 1.500 kg 80 mm</p>	<p><b>Scout</b></p>  <p>150 - 350 kg 160 - 200 mm</p>	<p><b>Integral</b></p>  <p>100 - 150 kg 100 - 200 mm</p>	<p><b>Integral twin</b></p>  <p>125 - 250 kg 100 - 150 mm</p>				
<p><b>Linea clinic</b></p>  <p>150 - 200 kg 125 - 150 mm</p>	<p><b>Forma</b></p>  <p>125 - 150 kg 125 - 150 mm</p>	<p><b>Aviana care</b></p>  <p>100 kg 75 mm</p>	<p><b>Aviana</b></p>  <p>75 mm</p>				
<p><b>Agila</b></p>  <p>40 - 100 kg 50 - 150 mm</p>	<p><b>Agila twin</b></p>  <p>50 - 100 kg 50 - 75 mm</p>	<p><b>Stora</b></p>  <p>60 - 160 kg 75 - 160 mm</p>	<p><b>Mono</b></p>  <p>30 - 70 kg 50 - 100 mm</p>				
<p><b>E-Drive</b></p>  <p>125 mm</p>	<p><b>Alpha</b></p>  <p>70 - 500 kg 80 - 200 mm</p>	<p><b>Delta</b></p>  <p>300 - 600 kg 125 - 200 mm</p>	<p><b>Delta twin</b></p>  <p>600 - 750 kg 125 - 200 mm</p>	<p><b>Galea</b></p>  <p>60 - 100 kg 100 - 125 mm</p>	<p><b>Levina</b></p>  <p>60 - 100 kg 75 - 150 mm</p>	<p><b>Linea</b></p>  <p>40 - 150 kg 50 - 150 mm</p>	<p><b>Anika</b></p>  <p>40 - 50 kg 55 - 75 mm</p>
<p><b>Zeta</b></p>  <p>300 - 800 kg 125 - 250 mm</p>	<p><b>Kappa</b></p>  <p>300 - 3.000 kg 80 - 300 mm</p>	<p><b>Kappa flex</b></p>  <p>360 - 750 kg 160 - 200 mm</p>	<p><b>Omikron</b></p>  <p>900 - 20.000 kg 100 - 500 mm</p>	<p><b>Lumina</b></p>  <p>10 - 100 kg 35 - 75 mm</p>	<p><b>Stylea</b></p>  <p>40 - 100 kg 35 - 100 mm</p>	<p><b>Smiles</b></p>  <p>40 kg 50 mm</p>	<p><b>Compacta</b></p>  <p>10 - 55 kg 14 - 50 mm</p>

# EXPERTISE THAT INSPIRES

## CONTACT US

We are a global company that offers you support on five continents. That means you can access on the spot support with an equal opportunity service and in-depth knowledge. Additionally, our experienced solution experts can advise you on the best mobility solution for your needs. Find your local TENTE contact on our website: [www.tente.com/locations](http://www.tente.com/locations)

## INCREASE YOUR EFFICIENCY

With our smart mobility solutions, we help you save time, effort, energy and operational costs. That means you can improve your working methods and conditions, thereby achieving optimisation of your processes and ensuring increased productivity, profitability and safety. Request our solution catalogue or read our website to see how our customers benefit from our customised solutions: [www.tente.com/solutions](http://www.tente.com/solutions)

## SAVE DEVELOPMENT TIME

You can find technical drawings and product data sheets on our website: [www.tente.com/anika](http://www.tente.com/anika)

## GET MORE INFORMATION

You can download catalogues and brochures on our website – and find useful information and customer references too: [www.tente.com/download](http://www.tente.com/download)





[www.tente.com](http://www.tente.com)



PRODUCTIVITY



SAFETY



DESIGN



DURABILITY



ENVIRONMENT